

# ONE PIECE | ARP



# One Piece | **ARP**

**Biotec ARP** implants are one-piece implants with an integrated gold color abutment. They are designed for use in very narrow alveolar ridges (mainly in maxillary lateral incisors and mandibular incisors) and for single-stage surgical procedures and cement restorations.

Maximum bend: approx. 25°. Only one bending operation may be performed. In the maxilla, the motorised insertion tool should be used due to its better implant guidance during insertion.



**Material** Titanium Alloy - Ti 6Al 4V ELI

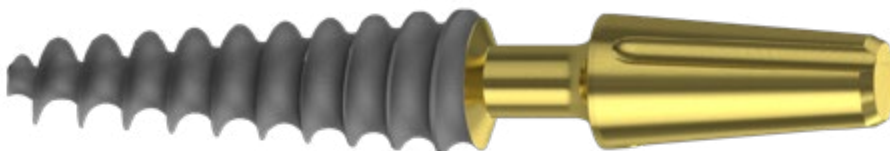

## Why choose Biotec ARP implants?

- Excellent gingival tolerance
- Ideal for narrow ridges and tight spaces
- For placement with small bone width (narrow bone)
- For immediate loading
- Trans-gingival gold colored
- The trans-gingival neck can be placed at bone level or below
- Easy insertion
- Self-tapping



# One Piece | ARP

## ARP Ø 3.2 mm

Upper Diameter  
Ø 3.2 mm

Lower Diameter  
Ø 2.15 mm

| Length  | Catalog Number |
|---------|----------------|
| 8 mm    | Bio-ARP3208    |
| 10 mm   | Bio-ARP3210    |
| 11.5 mm | Bio-ARP3211    |
| 13 mm   | Bio-ARP3213    |
| 16 mm   | Bio-ARP3216    |

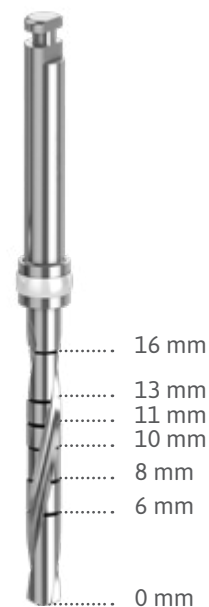

### Soft Bone (D3, D4)

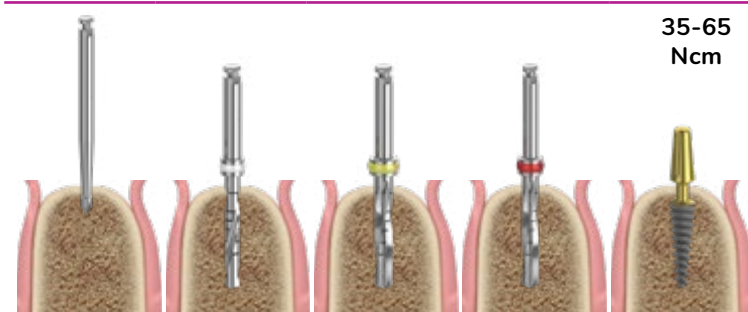

| Diameter (mm)     | Ø 1.9     | Ø 2.0    | Ø 2.5   | Ø 2.8   | Ø 3.2 |
|-------------------|-----------|----------|---------|---------|-------|
| Drill Speed (rpm) | 1200-1500 | 900-1200 | 500-700 | 500-700 |       |

### Hard Bone (D1, D2)

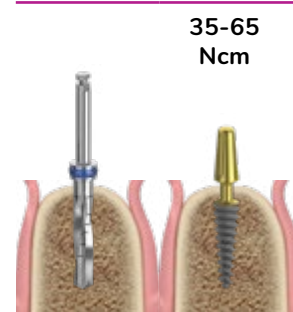

| Diameter (mm)     | Ø 2.8   | Ø 3.2 |
|-------------------|---------|-------|
| Drill Speed (rpm) | 500-700 |       |

\* Recommended insertion torque 35-60 Ncm

\* Procedure recommended by Biotec Implant Systems GmbH.  
Dental professionals should exercise their own judgment in each case.

# One Piece | ARP

## ARP Ø 3.7 mm

Upper Diameter  
Ø 3.7 mm

Lower Diameter  
Ø 2.72 mm

| Length  | Catalog Number |
|---------|----------------|
| 8 mm    | Bio-ARP3708    |
| 10 mm   | Bio-ARP3710    |
| 11.5 mm | Bio-ARP3711    |
| 13 mm   | Bio-ARP3713    |
| 16 mm   | Bio-ARP3716    |
| 18 mm   | Bio-ARP3718    |

### Soft Bone (D3, D4)

### Hard Bone (D1, D2)

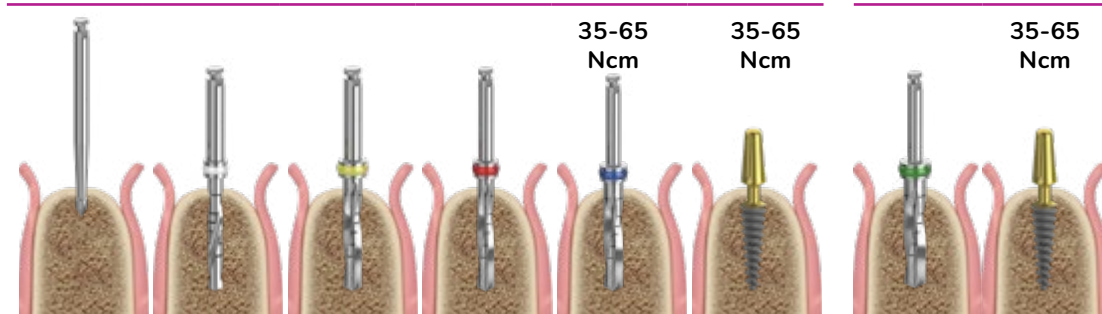

|                          |           |          |         |         |           |           |         |           |
|--------------------------|-----------|----------|---------|---------|-----------|-----------|---------|-----------|
| <b>Diameter (mm)</b>     | Ø 1.9     | Ø 2.0    | Ø 2.5   | Ø 2.8   | Ø 3.2     | Ø 3.75    | Ø 3.65  | Ø 3.75    |
| <b>Drill Speed (rpm)</b> | 1200-1500 | 900-1200 | 500-700 | 500-700 | 35-65 Ncm | 35-65 Ncm | 500-700 | 35-65 Ncm |

\* Recommended insertion torque 35-60 Ncm

\* Procedure recommended by Biotec Implant Systems GmbH.  
Dental professionals should exercise their own judgment in each case.

# One Piece | ARP

## ARP Ø 4.2 mm

Upper Diameter  
Ø 4.2 mm

Lower Diameter  
Ø 2.6 mm

| Length  | Catalog Number |
|---------|----------------|
| 6 mm    | Bio-ARP4206    |
| 8 mm    | Bio-ARP4208    |
| 10 mm   | Bio-ARP4210    |
| 11.5 mm | Bio-ARP4211    |
| 13 mm   | Bio-ARP4213    |
| 16 mm   | Bio-ARP4216    |
| 18 mm   | Bio-ARP4218    |

### Soft Bone (D3, D4)

### Hard Bone (D1, D2)

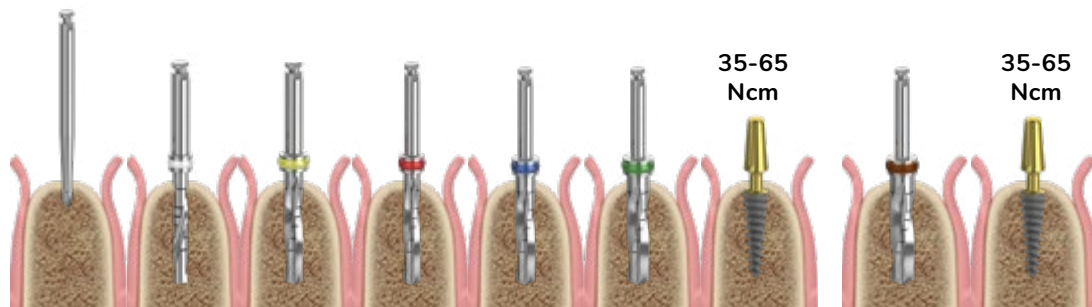

|                          |           |          |         |         |         |         |           |         |           |
|--------------------------|-----------|----------|---------|---------|---------|---------|-----------|---------|-----------|
| <b>Diameter (mm)</b>     | Ø 1.9     | Ø 2.0    | Ø 2.5   | Ø 2.8   | Ø 3.2   | Ø 3.65  | Ø 4.2     | Ø 4.0   | Ø 4.2     |
| <b>Drill Speed (rpm)</b> | 1200-1500 | 900-1200 | 500-700 | 500-700 | 500-700 | 500-700 | 35-65 Ncm | 500-700 | 35-65 Ncm |

\* Recommended insertion torque 35-60 Ncm

\* Procedure recommended by Biotec Implant Systems GmbH.  
Dental professionals should exercise their own judgment in each case.

# One Piece | ARP

## ARP Ø 5.0 mm

Upper Diameter  
Ø 5.0 mm

Lower Diameter  
Ø 3.2 mm

| Length  | Catalog Number |
|---------|----------------|
| 6 mm    | Bio-ARP5006    |
| 8 mm    | Bio-ARP5008    |
| 10 mm   | Bio-ARP5010    |
| 11.5 mm | Bio-ARP5011    |
| 13 mm   | Bio-ARP5013    |
| 16 mm   | Bio-ARP5016    |
| 18 mm   | Bio-ARP5018    |

### Soft Bone (D3, D4)

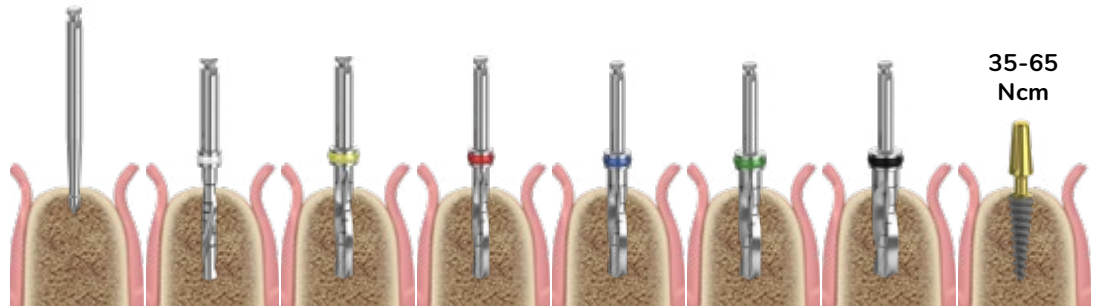

|                          |           |          |         |         |         |         |         |         |
|--------------------------|-----------|----------|---------|---------|---------|---------|---------|---------|
| <b>Diameter (mm)</b>     | Ø 1.9     | Ø 2.0    | Ø 2.5   | Ø 2.8   | Ø 3.2   | Ø 3.65  | Ø 4.2   | Ø 5.0   |
| <b>Drill Speed (rpm)</b> | 1200-1500 | 900-1200 | 500-700 | 500-700 | 500-700 | 500-700 | 500-700 | 500-700 |

### Hard Bone (D1, D2)

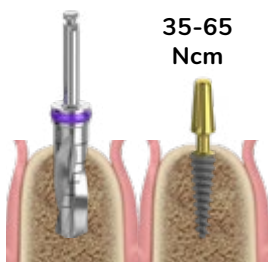

|                          |         |       |
|--------------------------|---------|-------|
| <b>Diameter (mm)</b>     | Ø 4.5   | Ø 5.0 |
| <b>Drill Speed (rpm)</b> | 500-700 |       |

\* Recommended insertion torque 35-60 Ncm

\* Procedure recommended by Biotec Implant Systems GmbH. Dental professionals should exercise their own judgment in each case.



info@biotec-implant.com  
T. +49.6196.6521096  
biotec-implant.com

Franzgraben 6,  
34125 Kassel,  
Germany

[www.biotec-implant.com](http://www.biotec-implant.com)